

FOR SALE OR LEASE

PROGRESSIVE  
REAL ESTATE PARTNERS

1.31 ACRES  
AVAILABLE

HARD CORNER 1.31 ACRES  
ADJACENT TO KAISER  
MEDICAL CENTER

NWC Iris Ave & Oliver Street,  
Moreno Valley, CA 92555



# THE OPPORTUNITY | NWC Iris Ave & Oliver Street, Moreno Valley, CA 92555



This site is perfectly situated to take advantage of the Kaiser Medical Center and their plans for expansion. The Kaiser adjacent to this site is currently developed as 130,000 SF 100-bed hospital and two medical office buildings totaling approximately 89,500 SF. Kaiser believes in the need of additional medical at this location and is planning a large phased expansion. The ultimate project buildout will be an approximately 460-bed hospital, outpatient medical office buildings, an energy center and structured parking for a total of 1,1250,000 SF of development. It is anticipated that construction on **the first phase will begin next year in 2020.**

The overall demographics of this location are some of the best in the Inland Empire. There is a population of over 11,000 within a one mile radius and an **average household income of over**

**\$110,000.** While the existing demographics are impressive there is significant growth coming to the immediate vicinity. **There are over 2100 residential units that are either approved or under construction within a 2 mile radius** mixed between both single family residential and multifamily. See map of proposed residential development attached in this OM.

In addition to residential growth there are other numerous economic drivers in the surrounding area. The site is well positioned to take advantage of growth the proposed World Logistics Center (WLC), a 40.6 million SF next-generation logistics campus designed to attract the world's leading companies. The site benefits from being only ¼ mile from the Via Del Lago entrance to Lake Perris with over 1 million visitors per year.

This site is part of an overall larger offering that contemplates a mixed-use development including senior living (age restricted, assisted and memory care are all permitted) and retail. Each component of the overall development compliments the other and creates a unique wellness-oriented synergistic opportunity for development.

# INVESTMENT OPPORTUNITY | NWC Iris Ave & Oliver Street, Moreno Valley, CA 92555



## OFFERING SUMMARY

Price:

**\$2,450,000**  
or Contact Broker  
for Lease Rate

total Land Area:

1.31 Acres

- Property is adjacent to the Kaiser Permanent Medical Center expanding in 2020
- Ideal for Food, Coffee, Car Wash or Hotel Uses
- Ideal location next to main entrance to Lake Perris which has over 1 Million visitors annually.
- Population of over 11,000 within a one mile radius and an average household income of over \$110,000
- There are over 2100 residential units that are either approved or under construction within a 2 mile radius
- This offering represents the parcels designated as medical oriented use but is part of a larger development concept including Senior Living and Retail offerings. Contact broker for additional opportunities at this site.
- Curbs, gutter and sidewalk installed with utilities available at the property line.
- Adjacent 15.57 Acre development site available, contact broker for details



# AERIAL MAP | NWC Iris Ave & Oliver Street, Moreno Valley, CA 92555



# OVERALL SITE PLAN | NWC Iris Ave & Oliver Street, Moreno Valley, CA 92555





## Kaiser Permanente Medical Center

The 101-bed Kaiser Permanente Medical Center features a 12-bed Emergency Department, and 14 labor and delivery room beds. With the continued growth expected in this geographic region, Kaiser Permanente is developing plans to expand access to high-quality care while incorporating advanced technologies and environmentally friendly features.

The ultimate project buildout will be an approximately **460-bed hospital**, outpatient medical office buildings, an energy center and structured parking for a **total of 1,1250,000 SF of development**. It is anticipated that construction on the **first phase will begin next year in 2020**.



## Elements of Proposed Expansion

### Hospital Support, ER, and Diagnostics & Treatment

- To accommodate 460 beds
- Will include radiology, laboratory, operating rooms
- Will include an emergency department with treatment rooms
- Administrative offices, conference rooms, cafeteria, and biomedical engineering to be included

### Outpatient Medical Office Buildings

Medical Offices to include:

- Exam rooms
- Physician Offices
- Outpatient Pharmacy
- Laboratories
- Radiology
- Administrative Offices
- Storage

### Central Energy Center and Service Yard

The Central Energy Center, emergency generator, bulk oxygen, and cooling tower would be included in Phase I and would serve the hospital, the diagnostic treatment building, and the outpatient medical buildings.

### Parking Facilities & Access

The project would have a total of 2,550 parking spaces and would include 3 new multi-level parking structures. The project would continue to have access from the existing driveway on Iris Ave.

### Sustainable Design Elements

The project would pursue Kaiser's sustainable building standards including:

- Solar & thermal insulation
- Utilization of rainwater
- Recycling of waste
- Energy recovery options
- Use of local materials for landscape & construction

# KAISER EXPANSION | NWC Iris Ave & Oliver Street, Moreno Valley, CA 92555

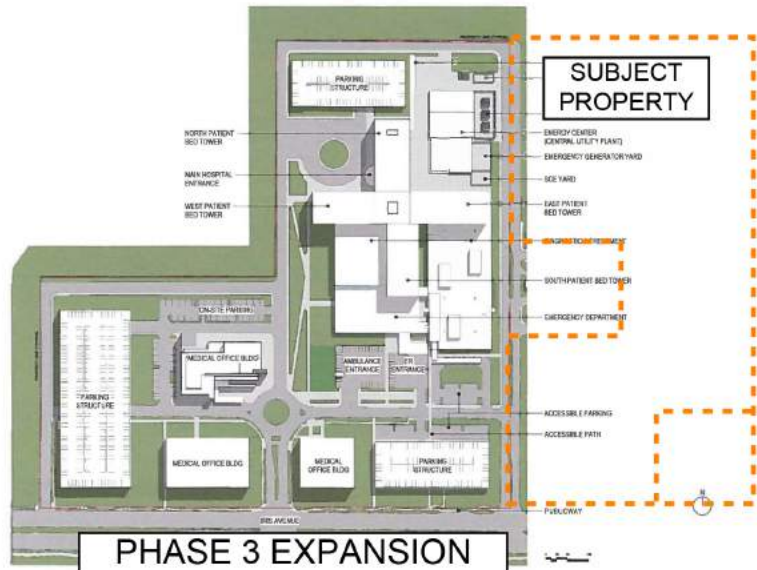
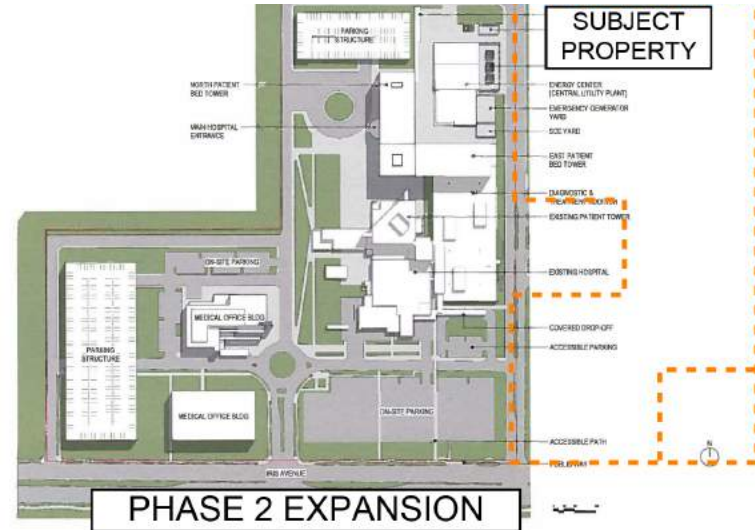
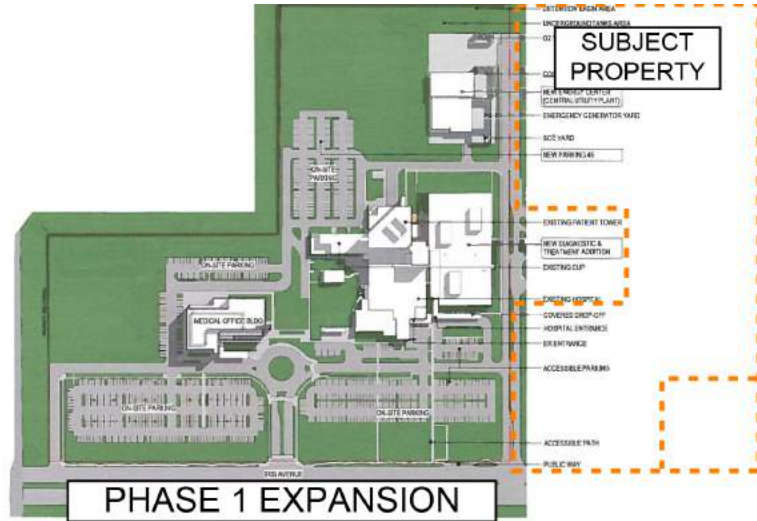



# WORLD LOGISTIC CENTER | NWC Iris Ave & Oliver Street, Moreno Valley, CA 92555



## WORLD LOGISTICS CENTER

Designed for large, global company's operations, the 2,610-acre, WLC campus will feature advanced technologies, innovative architecture, environmental design, water-conservation strategies and clean technologies. The press release said WLC is poised to become one of the preeminent business centers nationally and globally and will be one of the most sustainable developments, incorporating the highest environmental standards, of its kind.

The WLC campus design calls for development of up to 40.6 million sq. ft. of industrial, high-cube logistics facilities, office space and other support facilities. This site is at the junction of two major highways (SR-60 and I-215), which places it within overnight delivery range to 11 western states and within expedient reach to over 200 million customers.

A Highland Fairview press release says Moreno Valley is home to such companies as Proctor & Gamble, Amazon, Sketchers USA, Deckers Outdoor, Philips Electronics, Harman Kardon, Walgreens, Serta Mattress, Aldi Foods and Fisker Automotive. The management company said WLC will yield an estimated 13,000 construction jobs and 20,000 permanent jobs and will contribute approximately \$2.5 billion annually in economic activity.

Highland Fairview says it will provide nearly \$7 million to promote education, a library, training and workforce development for Moreno Valley residents.

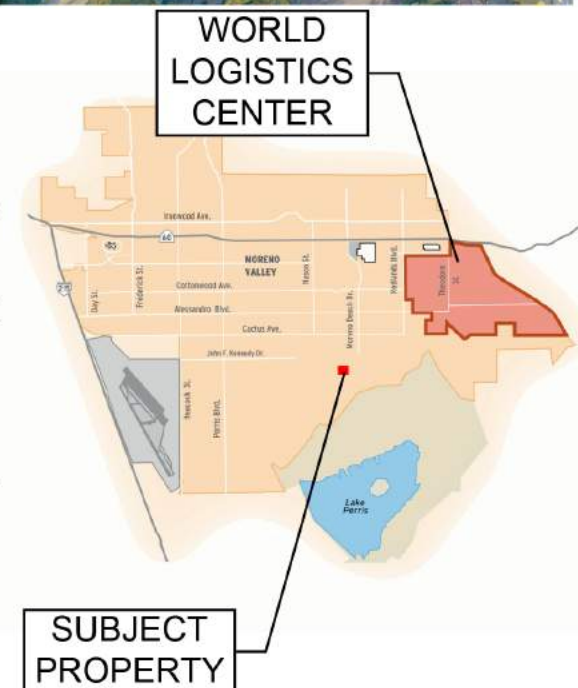



# WHY MORENO VALLEY? | NWC Iris Ave & Oliver Street, Moreno Valley, CA 92555



## ACCELERATING OPPORTUNITIES

### STRONG DEMOGRAPHIC GROWTH

Centrally located in the booming Inland Empire region of Southern California, Moreno Valley has a highly skilled and motivated workforce. The population exceeds 212,000 and approaches 2.4 million within a 20 mile radius. Average population growth is 4.99% annually, 4.53% within a 20 mile radius.

### PRO-BUSINESS PHILOSOPHY

Pro-business environment and concierge business service. Able to fast track development and offer unparalleled plan check turn around. Boasts City owned electric utility that is top in industry for reliability.

### HOT MORENO VALLEY MARKET

Home to many Fortune 500 and international companies.

Two medical campuses: Riverside University Health System and Kaiser Permanente with a full-time workforce exceeding 4,900.

Student population 41,000: UC Riverside, Moreno Valley College, Cal Baptist University.

Senior care and medical development opportunities.

### ATTRACTIVE INCENTIVES

Electrical rate discount for qualifying businesses. Workforce Recruitment and Training subsidy.



Moving at the Speed of Business | 951.413.3460 | edteam@morenovalleybusiness.com

Moreno Valley is the 2nd largest city in Riverside County and the 21st largest in California. With a 4.9% annual growth rate, the population of 212,682 spans across 51 square miles. The average household income is \$78,090, with 4500 businesses providing 17,000 jobs. The city has 6 high schools, 6 middle schools, 25 elementary schools, and two private schools. The three colleges—the University of California, Riverside, California Baptist University and Moreno Valley College—attract more than 40,000 students each year. In total, 44 universities and community colleges educate 225,655 undergraduates within 50 miles of the City Moreno Valley and is accessible through the California 60 and 215 freeways. The Perris Valley line of the Metrolink runs through Moreno Valley, providing quick and easy access to most cities between Perris and Downtown Los Angeles. With access to these transportation routes, Moreno Valley is a hub for education, growth and development.

The top employers in Moreno Valley are March Air Reserve Base, Amazon's Distribution Center, Riverside County Regional Medical Center, Moreno Valley Unified School District, and Ross For Less' Distribution Center. It was announced that Riverside County's hospital headquarters (Riverside University Health System) along with Kaiser Permanente both are expanding their facilities to meet strong regional demand.

As the City continues to grow, the commercial & retail sector is exploding. Currently Moreno Valley is home to over 2 regional malls and 40 shopping plazas. The largest regional mall is The Moreno Valley Mall with over 1.1M SF of retail activity and is anchored by Harkin Theaters, JC Penney, Macy's, & Sears. The second largest is Stoneridge Town Center at 579,000 SF of retail activity and anchored by Kohl's Super Target, Dress Barn, and Best Buy Outlet. Along with commercial & retail there are also Medical/Office as well as Industrial developments under way which would bring additional jobs and tax revenue to the growing city. Moreno Valley led the region in absorption of more than 8.4 million square feet of new industrial corporate facilities in the past two years. The proposed World Logistics Center alone offers 40.6 million square feet—and would be the largest industrial corporate business campus in California.



# DEMOGRAPHICS- 3 MILES | NWC Iris Ave & Oliver Street, Moreno Valley, CA 92555

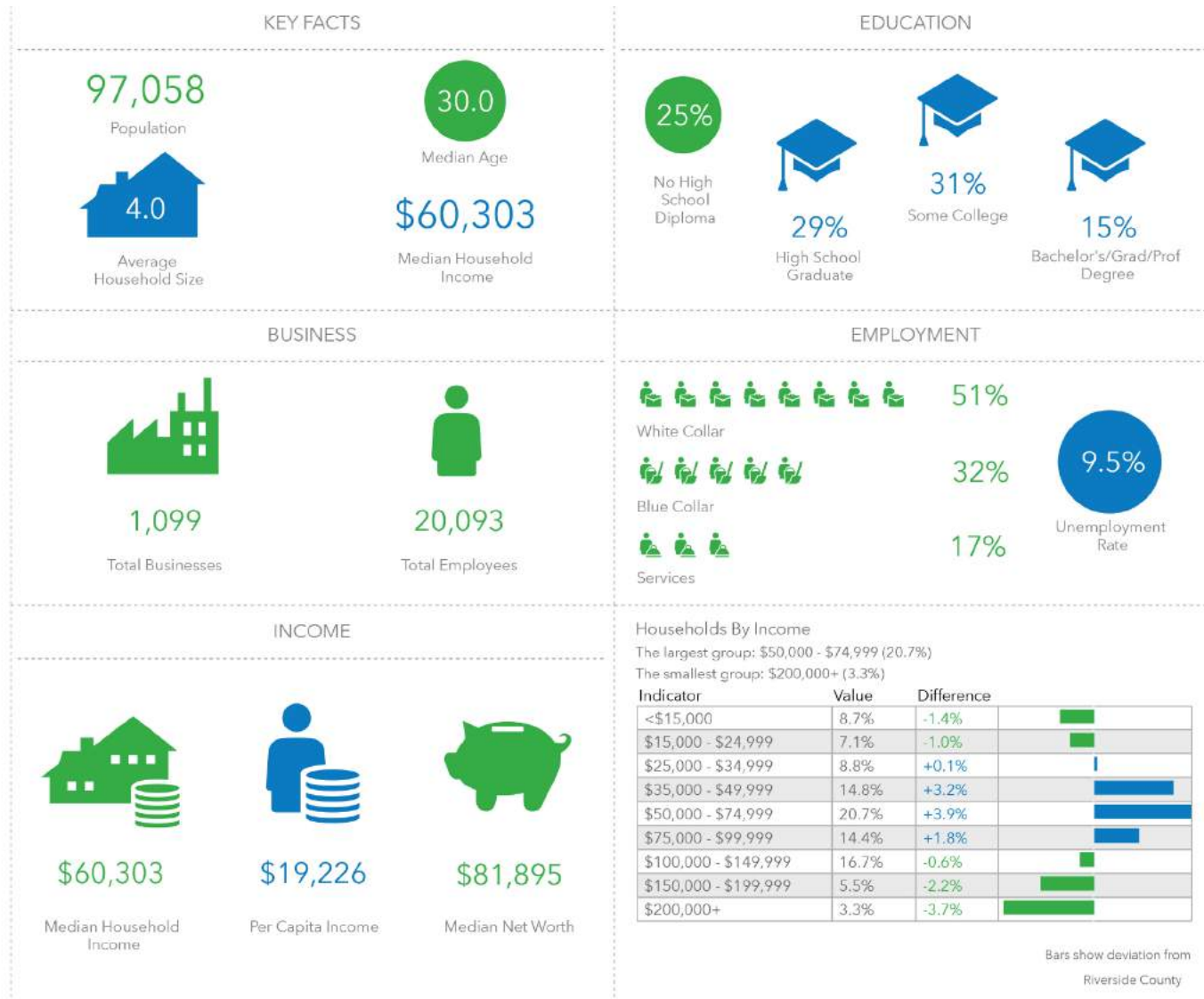



# DEMOGRAPHICS | NWC Iris Ave & Oliver Street, Moreno Valley, CA 92555

POPULATION	1 MILE	2 MILES	3 MILES
Total Population	26,078	62,025	97,058
Median age	28.8	28.0	27.9
Median age (Male)	27.3	26.9	26.6
Median age (Female)	29.6	28.7	28.9
HOUSEHOLDS & INCOME	1 MILE	2 MILES	3 MILES
Total households	5,047	20,382	35,072
# of persons per HH	3.7	3.7	3.7
Average HH income	\$72,970	\$73,355	\$76,473
Average house value	\$270,676	\$284,018	\$289,255

*\* Demographic data derived from Sites to Do Business*

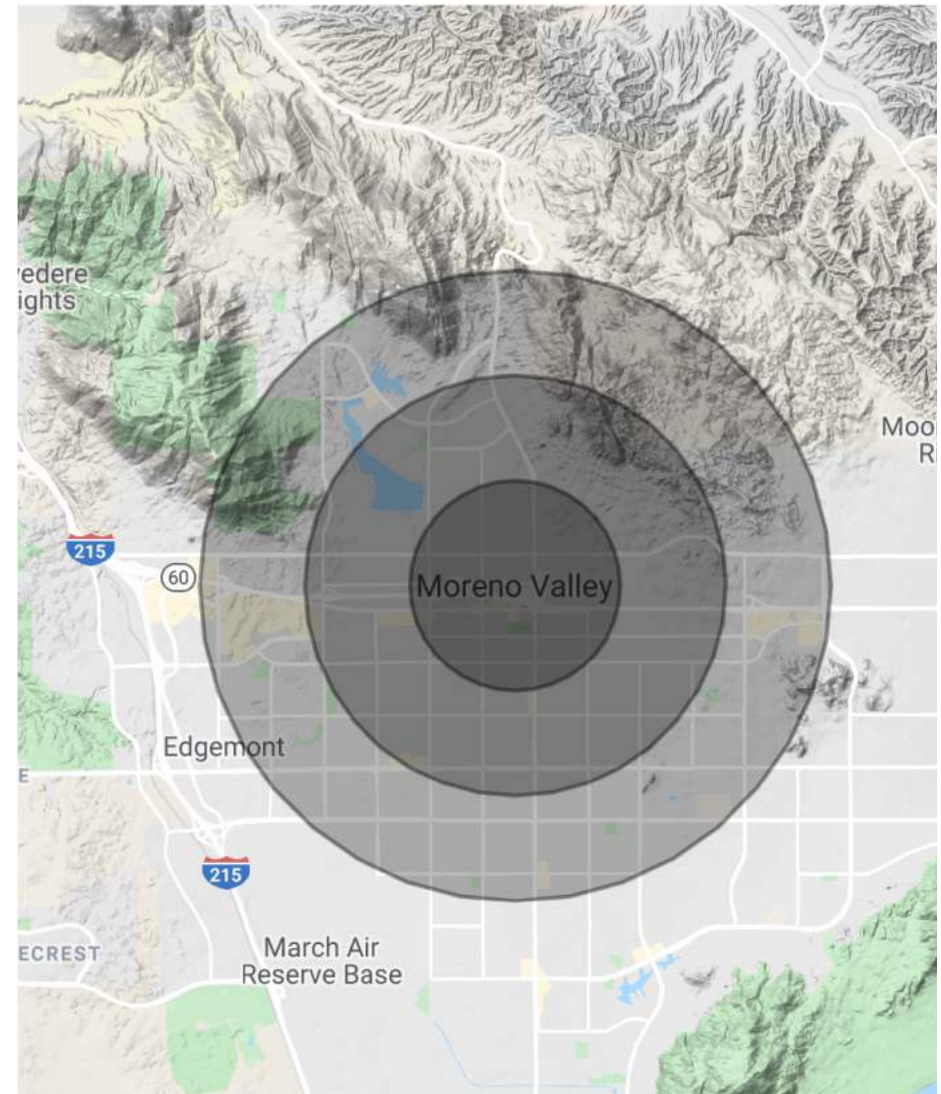





**PAUL GALMARINI**  
Senior Vice President

9471 Haven Avenue, Suite 110 | Rancho Cucamonga, CA 91730  
T 909.230.4500 | C 949.232.3032  
Paul@ProgressiveREP.com  
CalDRE #01816151

## BROKER CO-OPERATION

Progressive Real Estate Partners recognizes the importance of other brokers in the industry that actively represent prospective buyers. It is our policy to cooperate with such brokers. It is our policy to not cooperate with buyers/principals that are also licensed brokers.

Co-operating brokers should contact us directly for fee information.

## Confidentiality & Disclaimer

EACH PARTY SHALL CONDUCT ITS OWN INDEPENDENT INVESTIGATION AND DUE DILIGENCE.

Any party contemplating or under contract or in escrow for a transaction is urged to verify all information and to conduct their own inspections and investigations including through appropriate third party independent professionals selected by such party. All financial data should be verified by the party including by obtaining and reading applicable documents and reports and consulting appropriate independent professionals. Progressive Real Estate Partners makes no warranties and/or representations regarding the veracity, completeness, or relevance of any financial data or assumptions. Progressive Real Estate Partners does not serve as a financial advisor to any party regarding any proposed transaction. All data and assumptions regarding financial performance, including that used for financial modeling purposes, may differ from actual data or performance. Any estimates of market rents and/or projected rents that may be provided to a party do not necessarily mean that rents can be established at or increased to that level. Parties must evaluate any applicable contractual and governmental limitations as well as market conditions, vacancy factors and other issues in order to determine rents from or for the property.

Legal questions should be discussed by the party with an attorney. Tax questions should be discussed by the party with a certified public accountant or tax attorney. Title questions should be discussed by the party with a title officer or attorney. Questions regarding the condition of the property and whether the property complies with applicable governmental requirements should be discussed by the party with appropriate engineers, architects, contractors, other consultants and governmental agencies. All properties and services are marketed by Progressive Real Estate Partners in compliance with all applicable fair housing and equal opportunity laws.

Neither Progressive Real Estate Partners its directors, officers, agents, advisors, or affiliates makes any representation or warranty, express or implied, as to accuracy or completeness of the any materials or information provided, derived, or received. Materials and information from any source, whether written or verbal, that may be furnished for review are not a substitute for a party's active conduct of its own due diligence to determine these and other matters of significance to such party. Progressive Real Estate Partners will not investigate or verify any such matters or conduct due diligence for a party unless otherwise agreed in writing.

The information provided in this Offering Memorandum is confidential and can only be shared with those advisors that a buyer needs to share such information with in order to make an informed buying decision. All parties receiving this information shall not utilize this information to the detriment of the seller including, but not limited to, utilizing this information to solicit the seller's tenants for relocation to another property or contacting the tenants in any way relative to this property without the seller's prior written approval.